

NOT FOR CONSTRUCTION

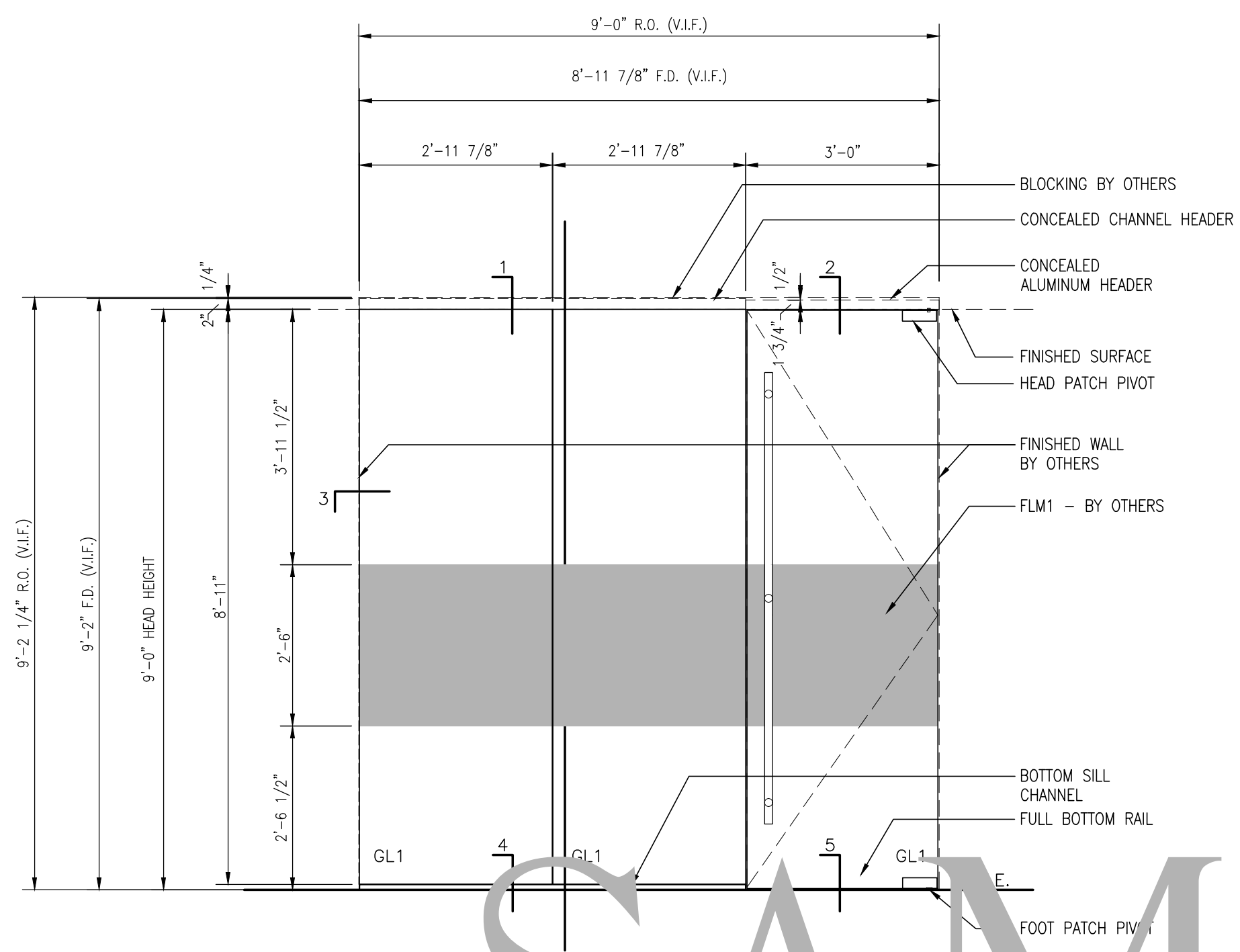

**1** ENCLAVE - 6005A  
SD-2 1 THUS  
QTY. 1 TOTAL 1/2" = 1'-0"

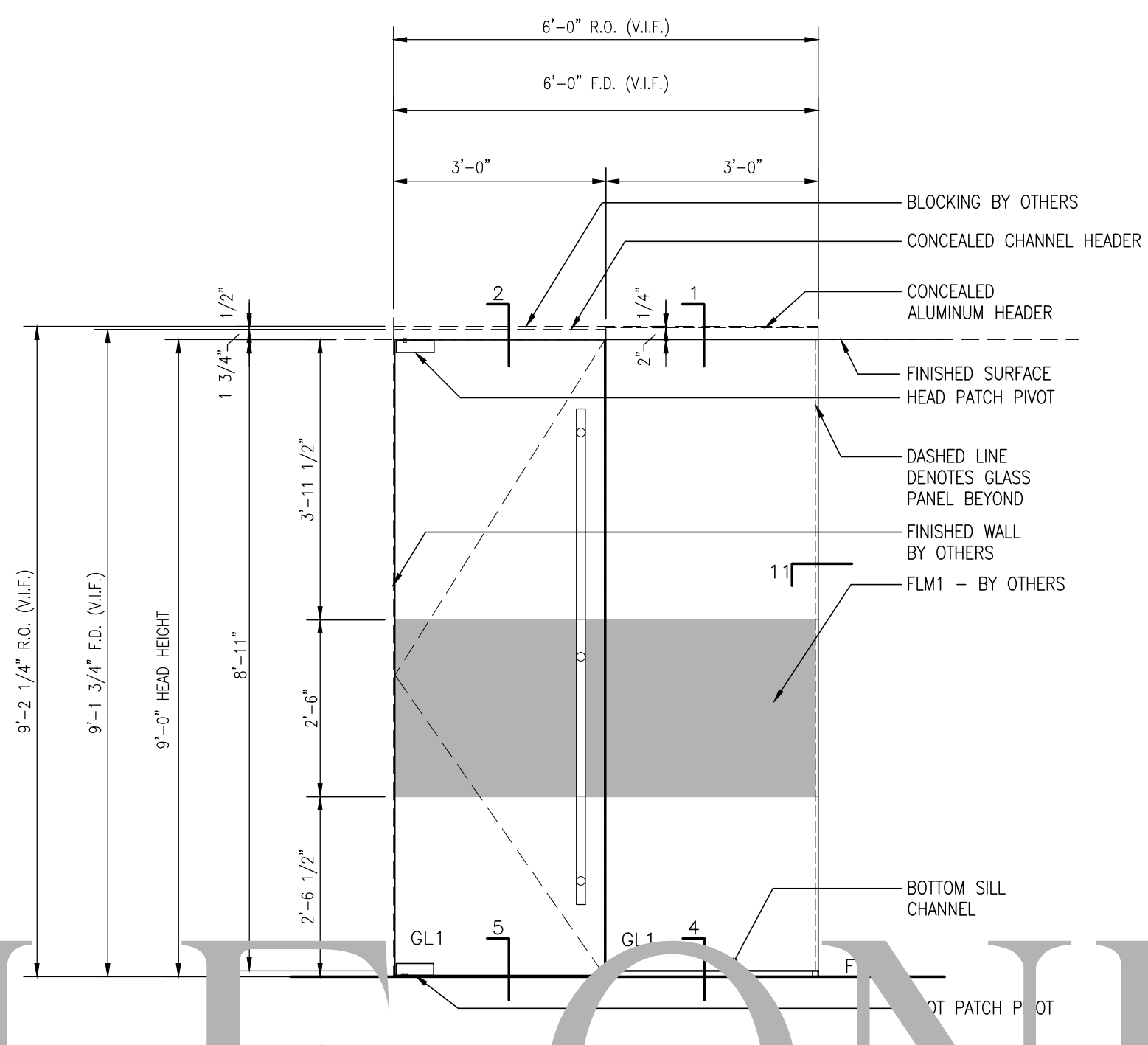

**2** CONFERENCE - 6006A  
SD-2 1 THUS  
QTY. 1 TOTAL 1/2" = 1'-0"

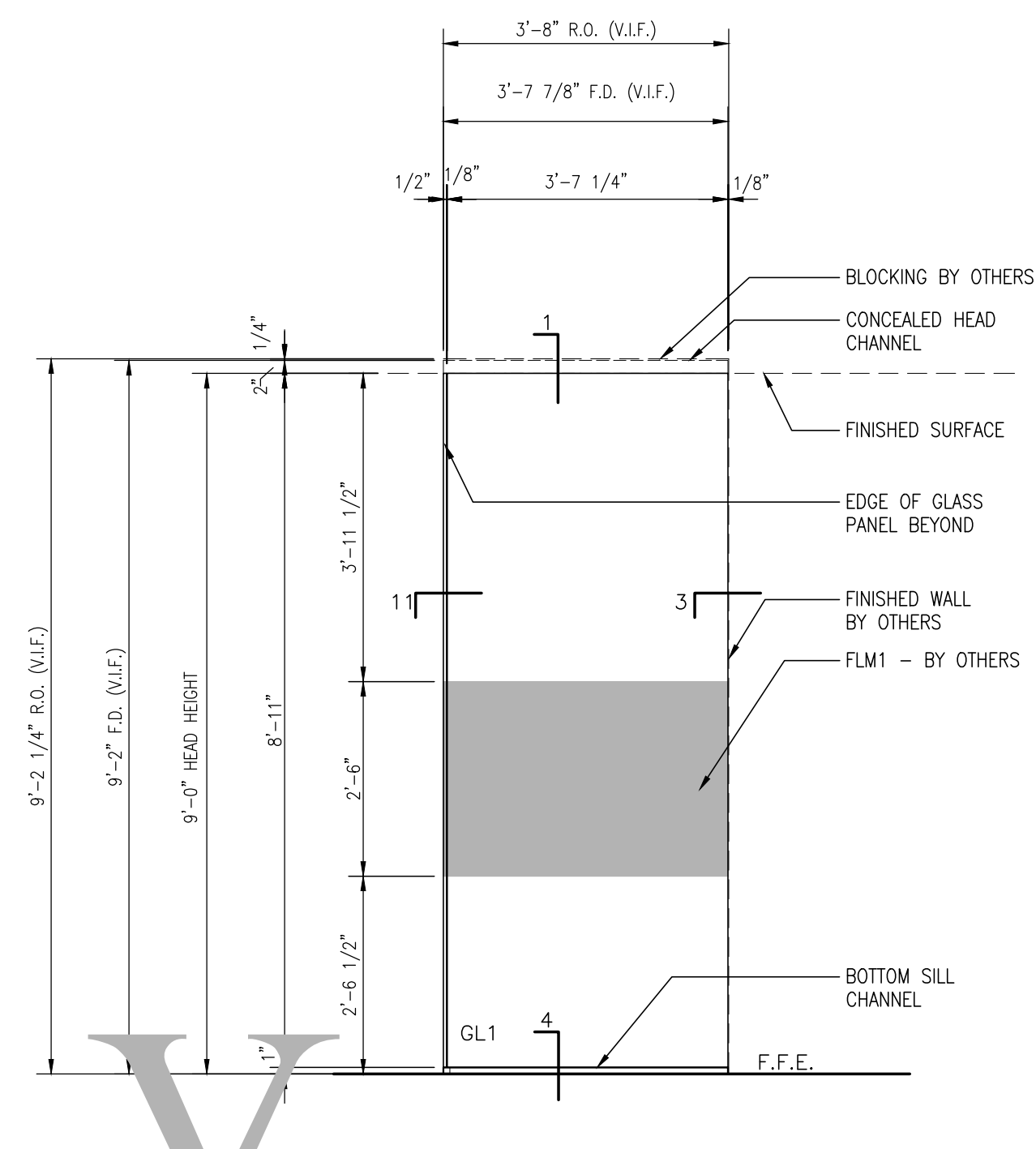

**3** CONFERENCE - 6006A  
SD-2 1 THUS  
QTY. 1 TOTAL 1/2" = 1'-0"

COPYRIGHT BY  
CREATIVE CONCEPTS AND DESIGN, INC.

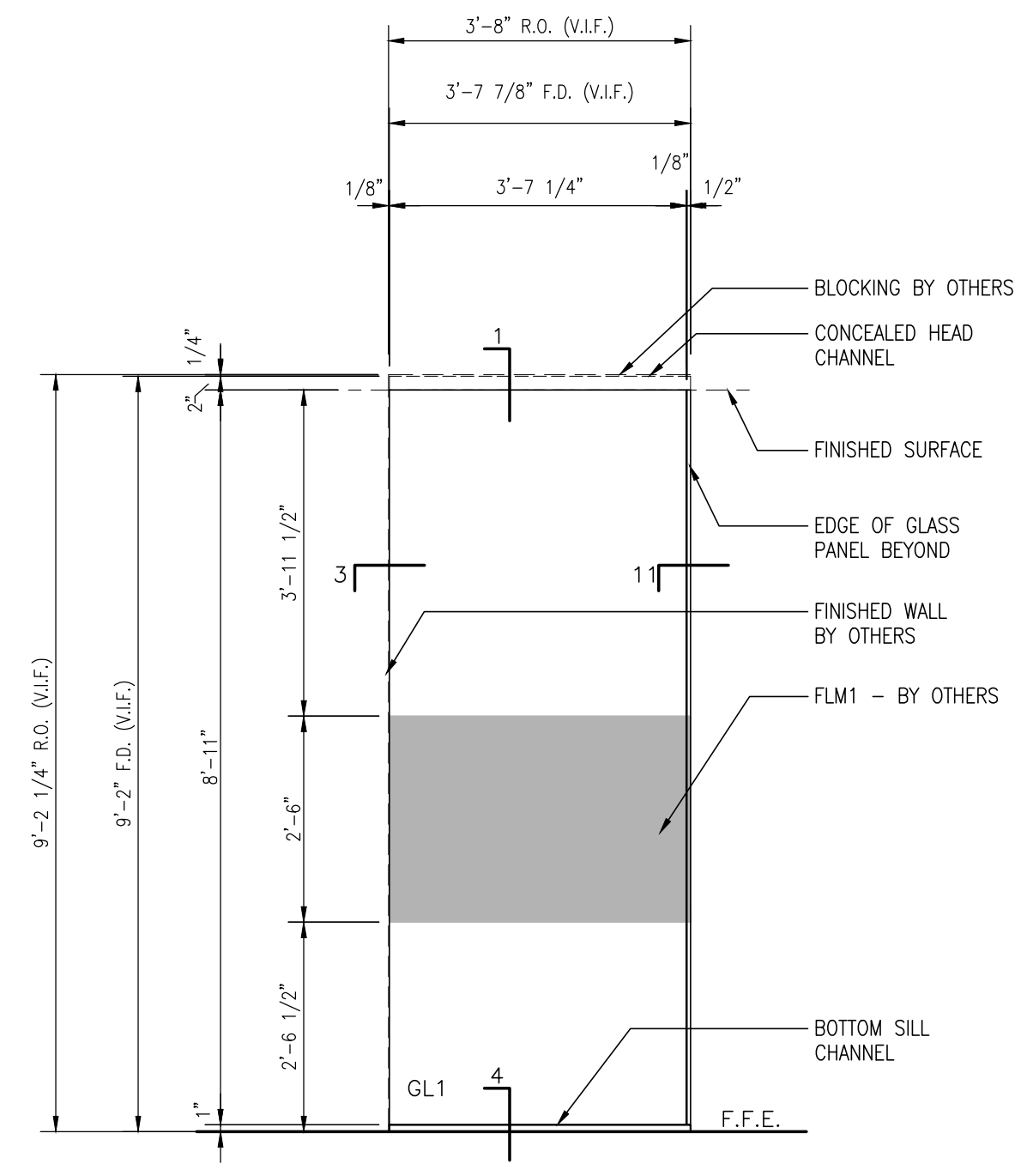

**4** CONFERENCE - 6007A  
SD-2 1 THUS  
QTY. 1 TOTAL 1/2" = 1'-0"

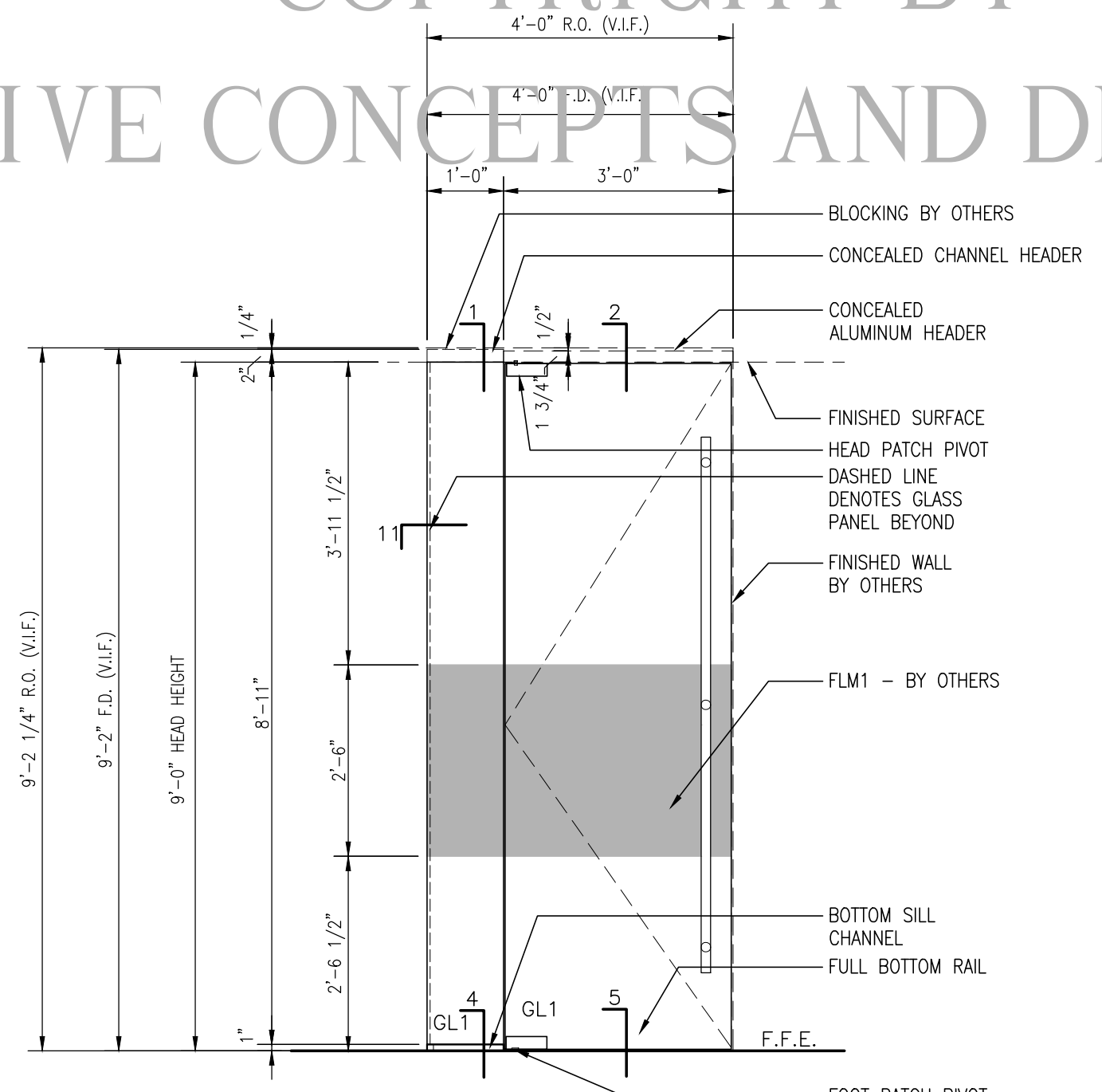

**5** CONFERENCE - 6007A  
SD-2 1 THUS  
QTY. 1 TOTAL 1/2" = 1'-0"

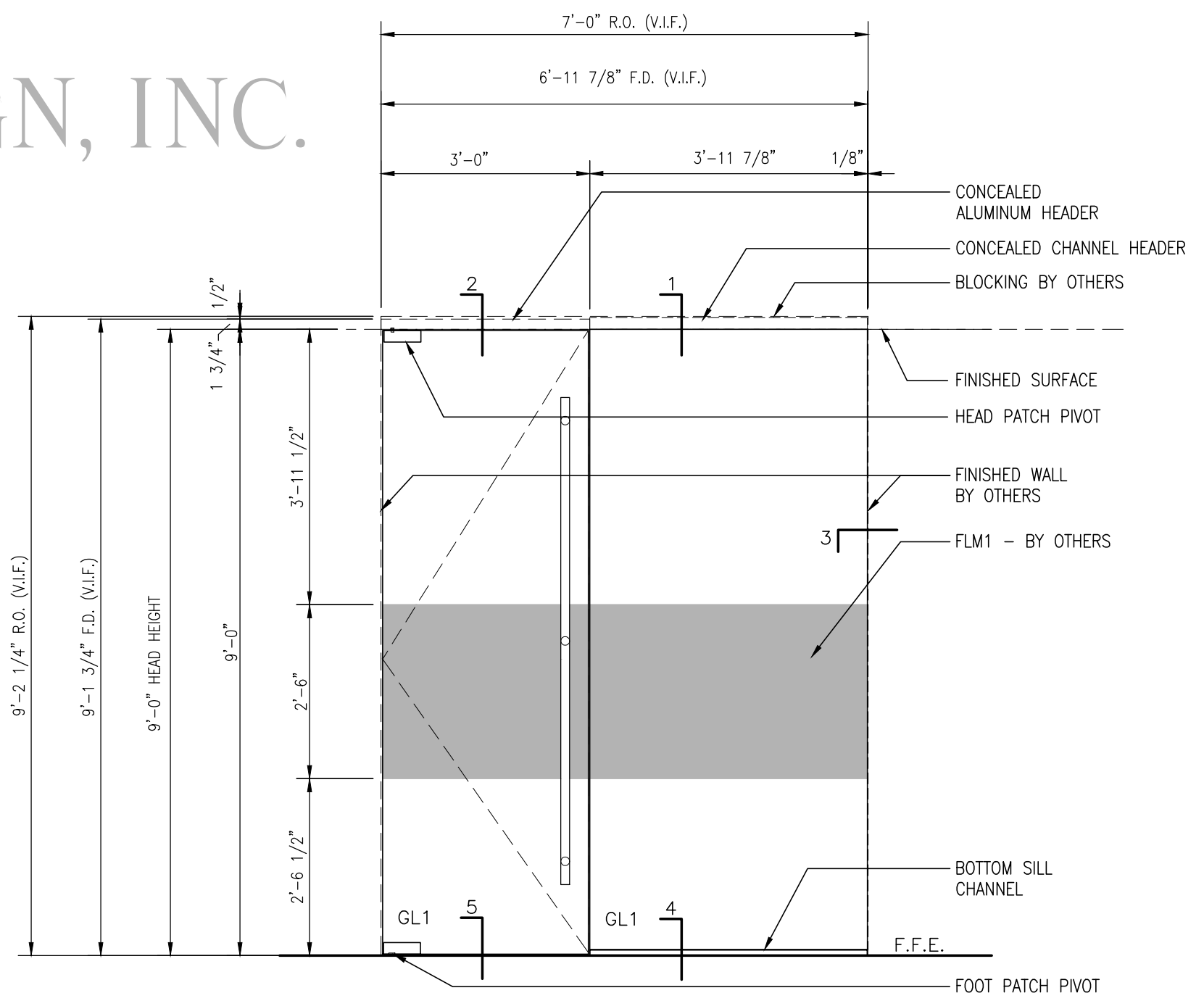

**6** ENCLAVE - 6008A  
SD-2 1 THUS  
QTY. 1 TOTAL 1/2" = 1'-0"

GENERAL NOTE:  
ALL DIMENSIONS TO BE VERIFIED IN THE  
FIELD (V.I.F.)

**GLAZING LEGEND:**

GL1	= 1/2" CLEAR TEMPERED
GL2	= 1/4" CLEAR TEMPERED
FLM1	= TRANSLUCENT FILM (BY OTHERS)

**PROJECT**  
Project Name:  
Location:  
Project No.:  
Manager:  
**ARCHITECT / CONTRACTOR**  
Architect:

Project No.:  
Contractor:

Attention:  
Sheet Title:  
**FRAME ELEVATIONS**

Date Issued: 4.20.15

- Revisions:
- 1.
  - 2.
  - 3.

Scale: 1/2" = 1'

Sheet No.:

FOR REVIEW ONLY