

SAMPLE ONLY

EXISTING BUILDING NEW CONSTRUCTION

COPYRIGHT BY
CREATIVE CONCEPTS AND DESIGN, INC.

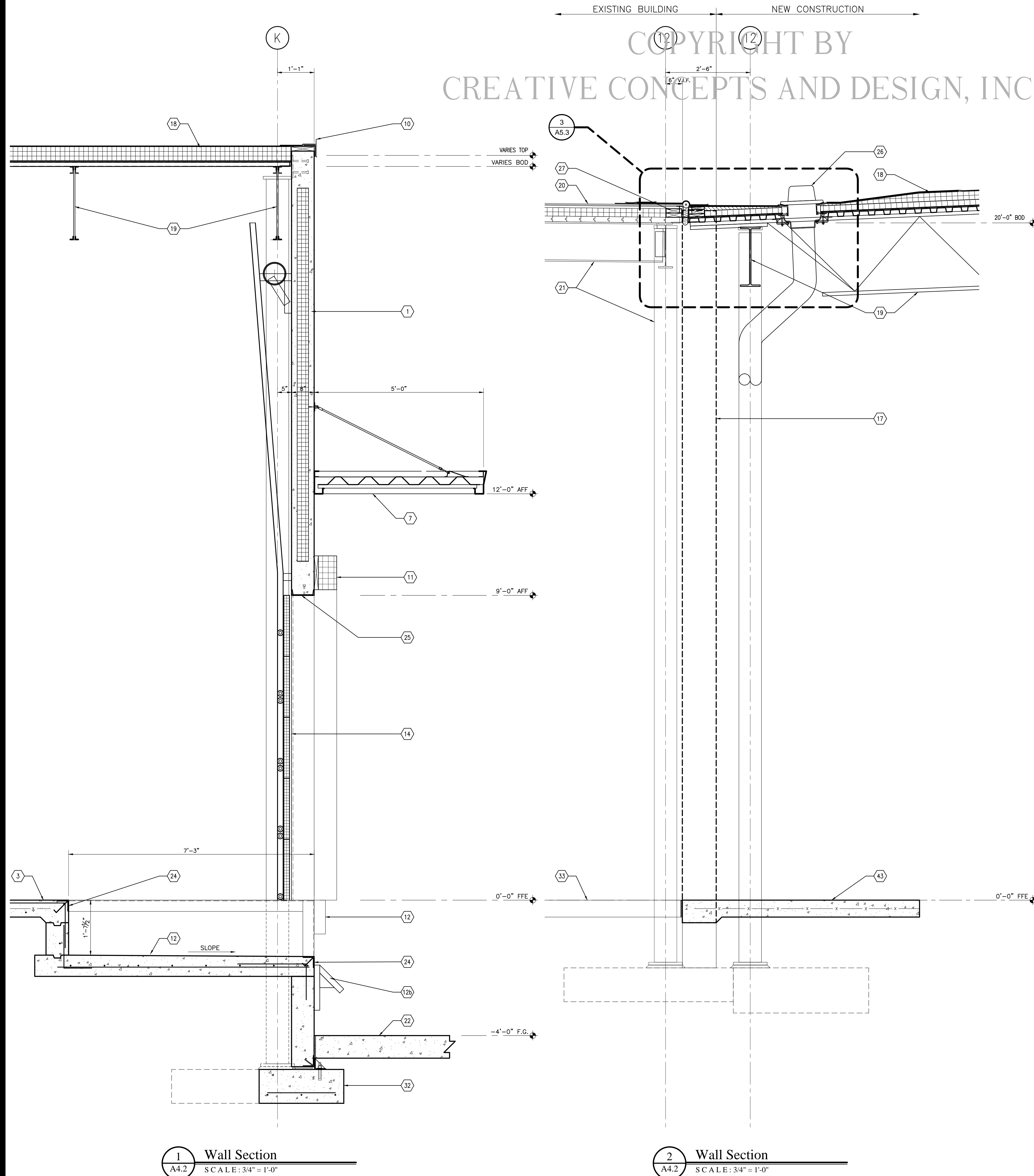

1 Wall Section
A4.2 SCALE: 3/4" = 1'-0"

2 Wall Section
A4.2 SCALE: 3/4" = 1'-0"

3 Gutter Detail
A4.2 SCALE: 1-1/2" = 1'-0"

4 Fascia Detail
A4.2 SCALE: 1-1/2" = 1'-0"

Section Notes:

1. NEW INSULATED (R10) PRECAST CONCRETE PANELS, PAINTED TO MATCH EXISTING. SEE STRUCTURAL FOR CONNECTIONS AND DETAILS.
2. NEW METAL STUD INTERIOR PARTITIONS. SEE WALL TYPE SCHEDULE FOR WALL TYPES.
3. NEW CONCRETE FLOOR SLAB OVER POLY. V.B. AND STONE FILL, SEE STRUCT. REFER TO FINISH SCHEDULE FOR FINISH.
4. NEW STEEL STAIR AND RAILING, PAINTED.
5. NEW CONC. RAMP TO GRADE, SEE STRUCT.
6. NEW 6" x 40" HIGH CONC. FILLED STEEL GUARD POST w/ VINYL COVER.
7. NEW PRE-FINISHED METAL CANOPY.
8. NEW PREFIN. METAL DOWNSPOUT.
9. NEW PREFIN. METAL GRAVEL STOP & GUTTER.
10. NEW PREFIN. METAL FASCIA.
11. NEW DOCK SEALS.
12. NEW DOCK LEVELER - BUILT-IN.
- 12a. NEW (EOD) EDGE OF DOCK LEVELER.
- 12b. NEW TRUCK RESTRAINT.
13. NEW DOCK BUMPER.
14. NEW INSUL. OVERHEAD DOOR.
15. NEW RAPID-ROLL DOOR.
16. NEW INSUL. HM DOOR & FRAME, PAINTED.
17. EXISTING MASONRY WALL. TRIM, REMOVE, AND PATCH WAREHOUSE SIDE AS REQ'D. TO ACCOMMODATE NEW WORK.
18. NEW 60 MIL TPO MEMBRANE ROOF ON R-30 RIGID INSUL.
19. STEEL FRAMING, PAINTED. SEE STRUCT.
20. EXISTING ROOF (NORTH BLDG.) = BUILT UP ROOFING ON 3/4" PERLITE ON 3" INSULATION ON 2" WOOD DECKING. = 6.5" TOTAL THICKNESS
21. EXISTING STEEL FRAMING.
22. CONC. APRON, SEE CIVIL.
23. CONC. SPLASH BLOCK
24. GALV. STEEL EDGE ANGLE
25. GALV. STEEL CHANNEL FRAME, PAINTED.
26. ROOF DRAIN SYSTEM, SEE PLUMBING.
27. EXISTING ROOF SYSTEM. TRIM, REMOVE, AND PATCH AS NEEDED TO ACCOMMODATE ROOF DRAIN SYSTEM.
28. CONC. RETAINING WALL, SEE STRUCT.
29. NEW 42" h STEEL GUARDRAIL, PAINTED.
30. EXISTING CMU AND BRICK VENEER WALL.
31. EXISTING CONC. SLAB FLOOR.
32. REINF. CONC. FOUNDATION, SEE STRUCT.
33. EXISTING CONC. FOUNDATION WALL.
34. EXISTING COPING.
35. EXISTING ROOF (SOUTH BLDG.) = BUILT UP ROOFING ON ?" PROTECTION BD. ON ?" INSULATION ON ?" METAL DECKING. = ?" TOTAL THICKNESS.
36. 2 HOUR FIRE RATED WALL; 6" METAL STUDS @ 24" O.C. W/ 2 LAYERS OF 5/8" FIRE RATED GYPSUM BOARD. UL-412
37. 2 HOUR FIRE RATED CEILING; 2-1/2" J-TRACK W/ 1" FIRE-SHIELD SHAFTLINER, 6" I-STUDS @ 2" O.C. AND 2 LAYERS OF 1-1/2" FIRE-SHIELD C GYPSUM BOARD. UL-438. - ADD (1) LAYER OF 5/8" GWB TO TOP SURFACE OF EXIT CORRIDOR.
38. STENCIL "2 HR. RATED CORRIDOR, NOT FOR STORAGE ABOVE" SIGNAGE @ 20'-0" O.C. IN 3" HIGH LETTERS.
39. NEW LAY-IN CEILING.
40. STEEL CHANNEL EDGING, PAINTED - SEE STRUCT.
41. COILING FIRE SHUTTER 1HR.
42. 5/8" HIGH IMPACT GWB TO 8'-0" A.F.F.
43. TURN DOWN CONC. SLAB TO EXISTING FOOTING THAT HAS BEEN REMOVED 8" BELOW F.F.E.
44. PROVIDE 8" CONC. TO TOP OF EXISTING FOOTING THAT HAS BEEN REMOVED.
45. NEW 1hr. RATED 12" CMU WALL TO STRUCT, PROVIDE REQUIRED FIRE CAULKING AT SIDES, ROOF DECK AND SEAL ALL PENETRATIONS. SEE STRUCTURAL FOR ADDITIONAL INFORMATION.
46. 6" STEEL BOLLARDS, SEE DETAIL 1/A5.4

NOT FOR CONSTRUCTION

Project:
Project No. 14269
Date Issued: JUNE 9, 2015
Revisions:

- 1.
- 2.
- 3.
- 4.
- 5.
- 6.
- 7.
- 8.
- 9.

Wall Sections
Sheet Title
CONSTRUCTION DOCUMENTS

A4.2
Sheet Number Of