

COMPREHENSIVE HIGH SCHOOL & TECHNOLOGY CENTER

SCHOOL DISTRICT ONE COUNTY, STATE

SAMPLE ONLY

COPYRIGHT
CREATIVE CONCEPTS AND DESIGN, INC.

Project Information

Aluminum: Exterior to be U.S. Aluminum 3250 Series 2-1/2" curtain wall with 5" back members and U.S. Aluminum Series IT451 2" x 4-1/2" thermally broken storefront. Interior to be U.S. Aluminum Series 451 2" x 4-1/2" non thermal storefront.

Doors: Exterior to be U.S. Aluminum Durafront Series 850 wide stile. Interior to be U.S. Aluminum Series 550 wide stile. All doors to have continuous gear hinges and 9-1/2" bottom rails and 9-1/2" muntons. Door hardware to be as specified in door schedule.

Door Hardware: Charlotte Glass / US Aluminum are providing doors only with hardware prep. Hardware by others. Doors to receive non-removable glass stops at all exterior locations. Doors to receive surface mounted closers per hardware schedule.

Windows: To be U.S. Aluminum Series 7400 fixed and casement.

Glass: To be as specified on glazing schedule.

Finish: To be clear anodized.

Additional Items:

Notes:

General Notes

1. **Limitations:** These drawings represent an interpretation of architectural information made available to United States Aluminum Corporation ("USAC"), and the placement of USAC systems within the project. USAC makes no representation or warranty as to the performance or completeness of the architectural details surrounding its systems and does not account for architectural information not provided to USAC.
2. **Confirmation:** Any USAC suggested dimensions, tolerances, deflection, anchorages, references, and functional performance requirements shall be confirmed with architect by installer, and validated by field measures to ensure performance compliance and architectural intent.
3. **Acceptance:** Final approval of these drawings constitutes acceptance of all deviations, if any, shown herein.
4. **Glazing:** USAC recommends delaying order of glass and/or glazing materials until final approval of erection drawings.
5. **Product Ratings:** USAC products are tested to rated performance measures. Information regarding specific performance ratings for the depicted systems is available from USAC, on request. Modification of depicted products or deviating from USAC shop drawings, installation recommendations, and/or good building practices can impact the ability of field installations to achieve tested rating(s).
6. **Installer:** In providing these drawings, USAC does not validate, endorse, represent, or otherwise warrant the competency or ability of the installing contractor(s) to assemble/address USAC systems in a manner sufficient to ensure compliance with desired/applicable design, energy, rating, building and/or safety codes.
7. **Use:** USAC assumes no responsibility for the use of these drawings by other trades.
8. **"NBUSA":** All items marked "NBUSA" are not supplied by USAC and are shown for informational purposes only.
9. **Protection:** Care should be taken to ensure USAC supplied products are protected before installation and isolated in installation, where appropriate, from contact with steel, concrete or other dissimilar materials.
10. **Compliance:** Owner, Architect and Dealer are responsible for selection, installation, and adjustment of systems to ensure compliance with all applicable design, energy, rating, building and/or safety codes.
11. **Installation:** USAC offers generally applicable installation recommendations for the systems depicted herein. Installation contractor must ensure compliance with USAC design intent and installation recommendations in addition to any project specific installation recommendations requested of USAC. USAC makes/issues no warranty or commitment relative to installed systems that do not comply with, or architecturally deviate from, USAC recommendations unless expressly approved by USAC before installation.

INDEX OF DRAWINGS

SD-1 COVER SHEET

PLANS

- SD-1.1 1ST FLOOR PLAN QUADRANTS A, B, D, E AND T
- SD-1.2 1ST FLOOR PLAN QUADRANTS C, F AND G
- SD-1.3 1ST FLOOR PLAN QUADRANTS H, J, M AND N
- SD-1.4 1ST FLOOR PLAN QUADRANTS K, AND L
- SD-1.5 2ND FLOOR PLAN QUADRANTS A, B, D, E AND T
- SD-1.6 2ND FLOOR PLAN QUADRANTS C, F, G AND S - 3RD AND 4TH FLOORS S

ELEVATIONS

- SD-2 CURTAIN WALL CW3250 FRAME ELEVATIONS
- SD-3 EXTERIOR STOREFRONT IT451 FRAME ELEVATIONS
- SD-4 EXTERIOR STOREFRONT IT451 FRAME ELEVATIONS
- SD-5 EXTERIOR STOREFRONT IT451 FRAME ELEVATIONS
- SD-6 INTERIOR STOREFRONT 450 SERIES ELEVATIONS
- SD-7 WINDOW 7400 SERIES FRAME ELEVATIONS
- SD-8 EXT. DOOR 850 / INT. DOOR 550 ELEVATIONS

DETAILS

- SD-9 CURTAIN WALL 3250 SERIES DETAILS
- SD-10 EXTERIOR STOREFRONT IT451 SERIES DETAILS
- SD-11 EXTERIOR WINDOW 7400 SERIES DETAILS
- SD-12 INTERIOR STOREFRONT 451 SERIES DETAILS
- SD-13 DOOR 850 SERIES / 550 SERIES DETAILS

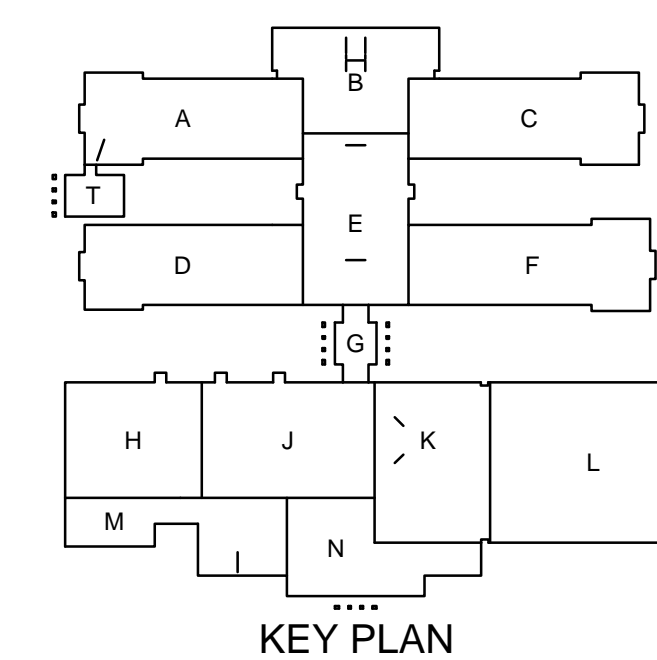

PROJECT

Project Name:
COMPREHENSIVE HIGH SCHOOL & TECHNOLOGY CENTER

Location:

Project No.:

Attention:

ARCHITECT

Architect:

Attention:

Architect Project No.:

CONTRACTOR

Contractor:

Attention:

SHEET TITLE

COVER SHEET

REVISIONS

- 1.
- 2.
- 3.

DATE ISSUED

10.23.08

SHEET NO.

SD-1.0

1 OF 19